

DWARKA PROJECT

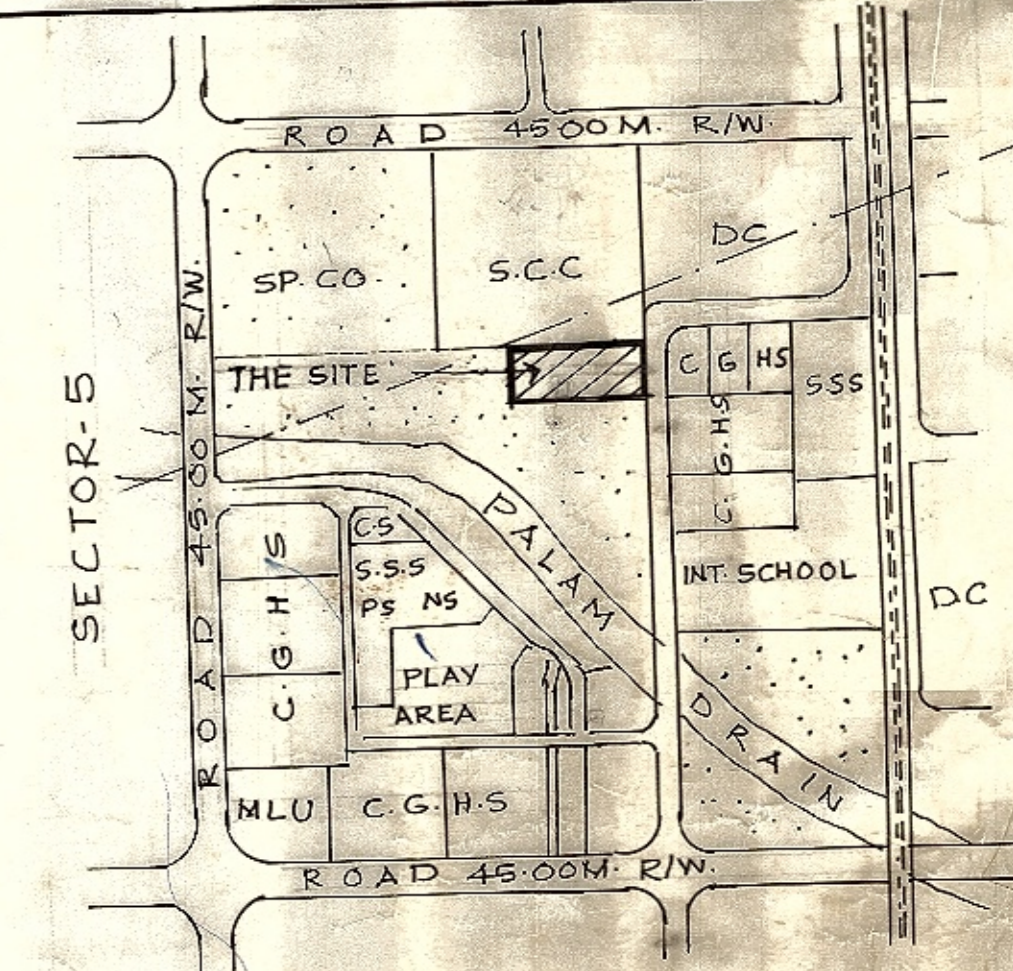

AREA STATEMENT

PRIMARY SCHOOL	4000.00 SQ.M.
DISPENSARY	1200.00 SQ.M.
COMM. ROOM	660.00 SQ.M.
OLD AGE HOME	2000.00 SQ.M.
NURSERY SCHOOL - I	800.00 SQ.M.
NURSERY SCHOOL - II	800.00 SQ.M.
RELIGIOUS BUILDING I	400.00 SQ.M.
RELIGIOUS BUILDING II	400.00 SQ.M.
CONVENIENT SHOPPING	1526.72 SQ.M.
CIRCULATION AREA	1853.28 SQ.M.
TOTAL AREA OF THE PLOT	13640.40 SQ.M.

HOUSING AREA FACILITIES (MODIFIED LAYOUT)

LAY OUT PLAN

PLG.D MAN	PLG ASST.	DATE
ASST. DIRECTOR	JTDIRECTOR	DIRECTOR

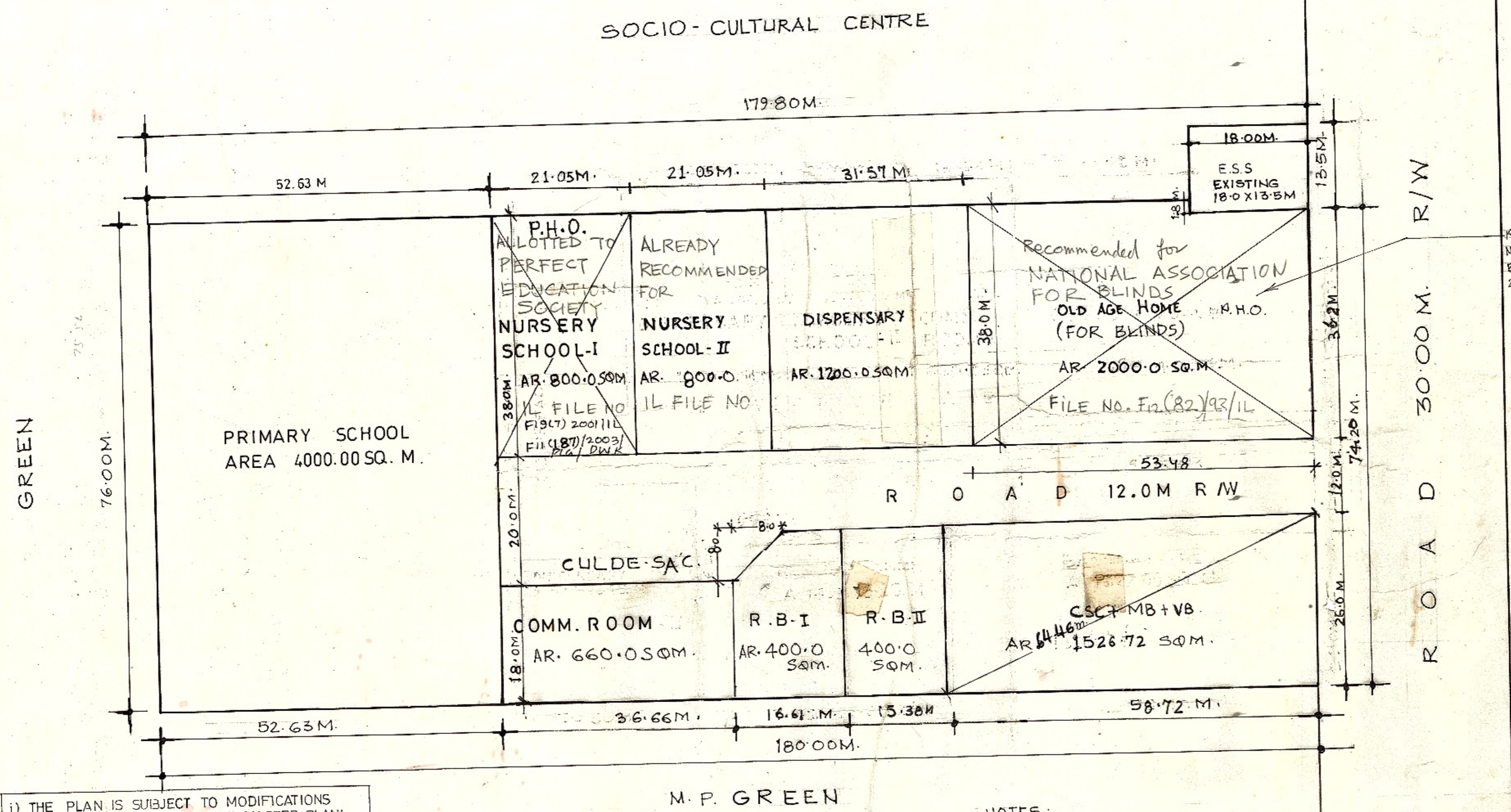

i) THE PLAN IS SUBJECT TO MODIFICATIONS WITHIN THE FRAMEWORK OF MASTER PLAN/ ZONAL PLAN.  
 ii) IT IS FOR PLANNING PURPOSE & IS NOT FIT TO BE PRODUCED IN THE COURT OF LAW FOR PROPERTY DISPUTES.  
 iii) ALL THE DIMENSIONS & AREA GIVEN IN THE PLAN ARE SUBJECT TO CONFIRMATION OF OWNERSHIP/ALLOTMENT STATUS AND DEMARCATIONS/FEASIBILITY REPORT FROM THE DDA LANDS & ENGINEERING WING RESPECTIVELY

AS PER THE LETTER NO. F-6(153)03/AE(D)/SWR-6/DDA/464 DT 24.03.04 FROM THE EX. ENG. SWR-6, DDA THE HAF RKT. IN SEC-II IS FEASIBLE AND HAS BEEN DEMARCATED AT SITE.

- NOTES:
- DO NOT SCALE THE DRG. FOLLOW ONLY THE WRITTEN DIMENSION.
  - ALL DIMENSIONS ARE IN METERS.
  - GRD. COVERAGE F.A.R & HEIGHT IS AS PER M.P.D. 2001.
  - THIS DRG IS MODIFIED ON THE BASIS OF FEASIBILITY/SITE REPORT GIVEN BY SURVEY UNIT DT: 16-4-03.
  - THIS DRG. WAS APPROVED IN 224<sup>TH</sup> SCREENING COMMITTEE MEETING HELD ON 24-6-03 VIDE ITEM NO. - 29. IN FILE NO. F-9(10)/94/DWK/HAF-B/Post-I

DELHI DEVELOPMENT AUTHORITY  
 APPROVED IN 224<sup>TH</sup> SCREENING COMMITTEE MEETING HELD ON 24-6-03 ITEM NO. 29, 2003  
 sd/- 24-7-03. C.A.  
 sd/- Comm/Plg

POSSESSION HANDER OVER TO NATIONAL ASSOCIATION FOR THE BLIND VIDE FILE NO. - F-11(179) 2003/PLG/DWK.